



6/773 South Dowling Street Redfern NSW

1  1 

Furnished room located in a character filled 4-level Victorian terrace in a highly sought East Redfern precinct bordering Surry Hills.

Price : \$320 pw
View : <https://www.legendproperty.com.au/lease/nsw/eastern-suburbs/redfern/residential/terrace/8120695>

Featuring common kitchen and multiple modern bathrooms, sunny rooftop garden area entertaining with lovely district views and a communal lounge with snooker table.

This terrace has dual access via South Dowling St and with rear lane access via Madison Lane.

Shared laundry with coin operated washer/dryers and a common kitchen.

Water, electricity and WIFI all included.



Lei (tracy) Huang
0493186991



Even Ang
0423438362



LEVEL ONE



LEVEL TWO

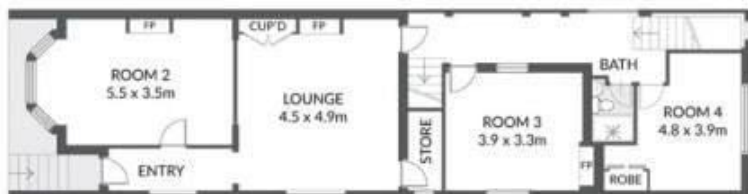

ENTRY LEVEL

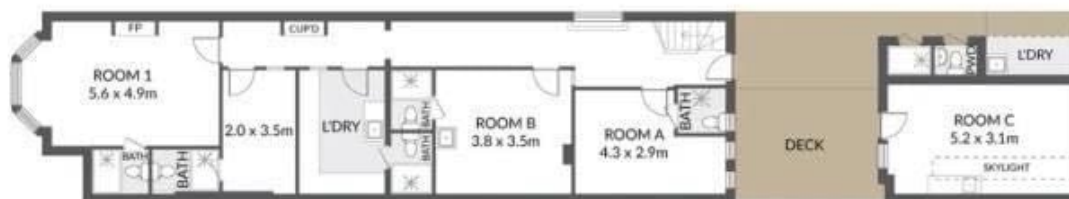

LOWER LEVEL

773 South Dowling Street, Redfern



Disclaimer: Floor Plan measurements are approximate and are for illustrative purposes only. While we do not doubt the floor plans accuracy, we make no guarantee, warranty or representation as to the accuracy and completeness of the floor plan. You or your advisors should conduct a careful, independent investigation of the property to determine to your satisfaction as to the suitability of the property for your space requirements.