



**2406/91 Liverpool Street Sydney NSW**

Rent at \$900 per week with a high return of 5.32%.

Located in this designer apartment building World Tower, this apartment has stylish, luxurious and panoramic views to create a quality lifestyle and ultimate convenience.

The property also enjoys an exceptional CBD position within a stroll to all the attractions that make this city so popular with restaurants, Hyde Park, Chinatown, and train stations all close by.

**Features:**

- Highly designed interior layout with an open living space, one bedroom and one spacious study room which definitely approaches a second bedroom.
- Spectacular balcony providing abundant natural light whilst capturing the fantastic City views and Darling

1  1 

**Price** : \$880,000

**View** : <https://www.legendproperty.com.au/sale/nsw/sydney-city/sydney/residential/apartment/8031174>

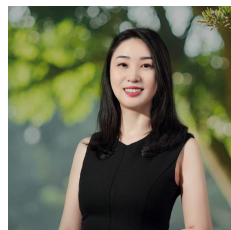

**Min (Lily) Chang**  
0405 323 411

**Shenyong (James) Shen**  
+61404843268

# 1 BED + STUDY UNIT

UNIT 1801, 2101, 2201, 2301, 2401, 2501

MIRROR UNIT 1806, 1906, 2106, 2206,  
2306, 2406, 2506

AREA = 62.9m<sup>2</sup>

Level 18 - 25



LEGEND  
PROPERTY



- Wall to wall glass leading to lovely entertainment terrace
- Full bathroom

## PURCHASERS TAKE NOTE

These floorplans DO NOT FORM PART of the Contract for Sale of any lot within the development. They are INDICATIVE ONLY. The descriptions, layouts and areas set out in this floor plan are subject to change and may not accurately reflect the final design of each unit depicted.



METRO BLUE

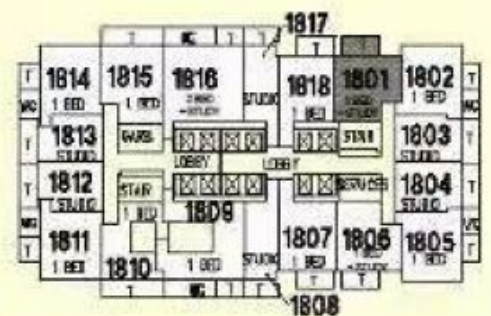

GEORGE STREET