



**1510/178 Thomas Street Haymarket NSW**

2 🛏️ 2 🚿 1 🚗

This ultra-contemporary designer masterpiece is situated in a central community setting, making it an ideal choice for professional couples or discerning investors. Positioned on the 15th floor, this property offers a low-maintenance lifestyle with a pleasant outlook, embodying the epitome of inner-city living.

**View** : <https://www.legendproperty.com.au/sale/nsw/sydney-city/haymarket/residential/apartment/7896738>

Great location at Sydney CBD, The Quay Haymarket has 270 residential apartments across 2 towers with 6,000 square metres of retail space including a new Woolworths supermarket and specialty retail, easy access to shopping dining and entertainment. Walk to Darling Harbour, Chinatown, UTS, TAFE, light rail, central Station.



**Lei (tracy) Huang**  
0493186991

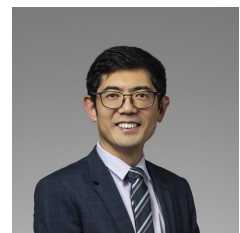

**Yang (Bryan) Ge**  
0451 820 519

**Key features:**

- Modern Two Bedroom Apartment with security parking and storage

1510/178 THOMAS STREET, HAYMARKET

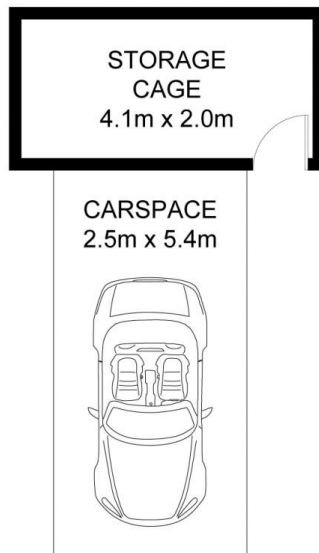
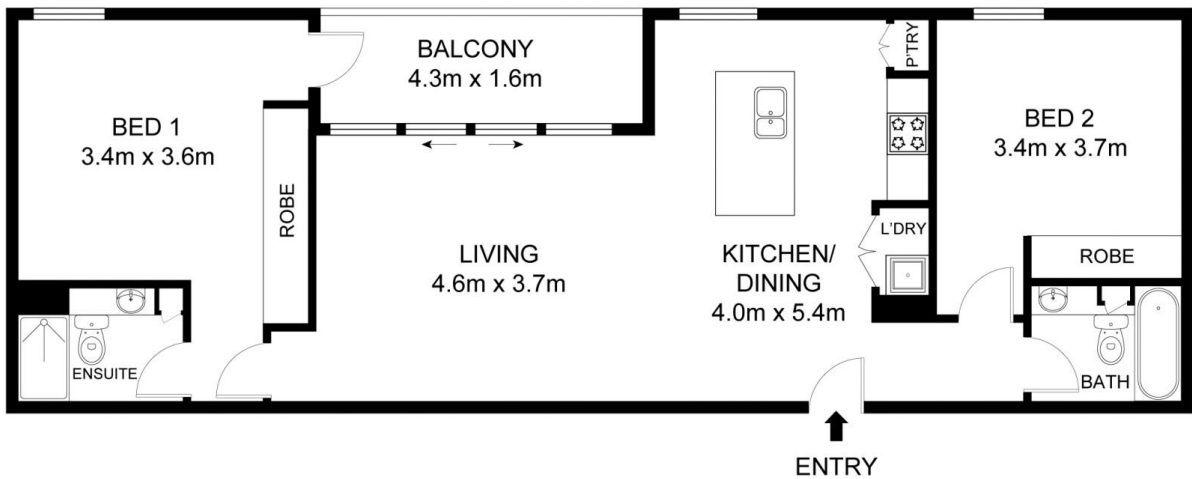

Int: 85 m<sup>2</sup>  
 Ext: 7 m<sup>2</sup>  
 Total: 92 m<sup>2</sup>

THE ABOVE PLAN IS REPRESENTATION ONLY. ALL DIMENSIONS ARE APPROXIMATE SHOULD BE CHECKED ON SITE.  
 NO RESPONSIBILITY IS TAKEN FOR ERROR, OMISSION OR MISSTATEMENT.